

Energel™ Wound Hydrogel

Compatible with Procellera™ Wound Dressings

Instructions for Use

Description

Energel™ Wound Hydrogel is a sterile and water-soluble gel formulated to maintain a moist wound environment and provide moisture to a dry wound. Energel may be used to moisten Procellera™ Wound Dressings.

Indications

Energel Wound Hydrogel is intended to cover a wound to protect against abrasion, friction, desiccation, and contamination.

Contraindications

None known.

Warnings and Precautions

- Single use only.
- For external use only.
- Discard product if packaging is damaged or evidence of contamination is present.
- Bleeding should be controlled before application of cover dressings.
- Do not use on patients with known sensitivity to parabens.

Application

1. Cleanse wound and surrounding skin prior to application.
2. Moisten dressing with a thin, even layer of Energel and place onto wound or apply enough Energel to cover the wound base.
3. Apply appropriate cover dressing(s) to help manage wound drainage and maintain a moist wound environment.

Removal and Disposal

- Gently remove gel from wound site.
- Discard after single use.

Storage

- Store in a cool dry place.
- Store away from direct sunlight.

Procellera™ Power Pack

Wound Dressing Kit

Instructions for Use

Procellera™ Single Layer Antimicrobial Wound Dressing
Powered by V.Dox™ Technology

Procellera™ Composite Antibacterial Wound Dressing
Powered by V.Dox™ Technology

Energel™ Wound Hydrogel
Compatible with Procellera™ Wound Dressings

Vomaris Wound Care, Inc.
1911 East Fifth Street
Tempe, AZ 85281, USA
(866) 496-8743 (480) 921-4948
www.vomaris.com



© 2019 Vomaris. All rights reserved.
Procellera, Energel, V.Dox, Vomaris, and Vomaris logo are trademarks of Vomaris Innovations, Inc.
PATENTED. See www.vomaris.com.

Procellera™ Single Layer Antimicrobial Wound Dressing

Instructions for Over-the-Counter Use

Description

Procellera™ Single Layer Antimicrobial Wound Dressing (Procellera Single Layer) features V.Dox™ Technology. Embedded in the dressing are microcell batteries made of elemental silver and elemental zinc applied in a dot-matrix pattern to a polyester substrate. In the presence of a conductive medium such as wound exudate, water-based wound hydrogels, saline, or water, microcurrents are generated at the dressing surface due to its inherent design.

Procellera Single Layer is a broad-spectrum antimicrobial wound contact layer to be used under a secondary dressing (not included) to keep the dressing in place and help maintain a moist wound environment. Note: Product is not made with natural rubber latex.

Silver and zinc in the dressing help to preserve it and minimize or prevent the growth of microorganisms within the dressing.

Indications

Procellera Single Layer Antimicrobial Wound Dressing is intended for the management of wounds to provide a moist wound environment and is indicated for superficial wounds such as minor cuts, scrapes, irritations, abrasions, blisters, etc.

Contraindications

- Do not use on individuals with sensitivity or allergy to silver, zinc, or other dressing components.

Warnings

- Frequent or prolonged use of this product may result, in rare occasions, in temporary discoloration of the skin.

Precautions

- Single use only.
- For external use only.
- Do not use if the pouch is open or damaged prior to use.
- Do not apply Procellera Single Layer with topical agents such as antibiotic creams or ointments, enzymatic debriders, silver or zinc creams, oxidizing agents, or petroleum-based products.
- Secondary dressings should be used as stated in their instructions for use.
- Stop using Procellera Single Layer and consult a physician if allergy, irritation, increased pain, maceration, or irregular skin discoloration occurs.
- Procellera Single Layer is not intended to be used on wounds with uncontrolled bleeding.
- Remove Procellera Single Layer during energy-based procedures (such as radiofrequency, ultrasound, or radiation) where the dressing may interfere with delivery.
- MR unsafe. Remove Procellera Single Layer prior to a MRI or HBOT procedure and apply a new dressing after the procedure.
- Avoid direct dressing contact with electrodes or conductive gels during electronic measurements; e.g., EEG (electroencephalogram) or ECG (electrocardiogram).
- Infected wounds should be treated under a physician's supervision.
- The safety of daily Procellera Single Layer use for longer than 28 days has not been studied.

Application

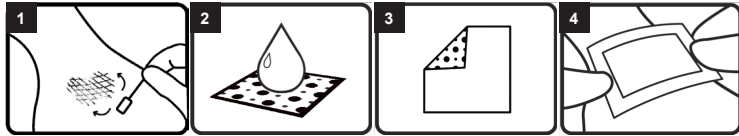

- Cleanse wound area with an appropriate wound cleanser.
Note: If needed, cut Procellera Single Layer to a shape that will extend 1 to 2 cm beyond wound edges (cutting may result in fraying of the dressing).
- Moisten Procellera Single Layer with sterile saline, water, or a thin, even layer of wound hydrogel.
- Apply Procellera Single Layer with the dotted side down in direct contact with the wound.
- Cover Procellera Single Layer with an appropriate sterile secondary dressing to help maintain a moist wound environment and secure in place.
Note: Keep Procellera Single Layer moist by re-moistening as necessary.

Site Care and Dressing Change

- Procellera Single Layer may be left in place for up to 7 days. Earlier and/or more frequent changes may be required, depending on the amount of drainage present and the condition of the wound and/or the surrounding skin. Inspect the wound site periodically.
- To remove Procellera Single Layer, gently pull back. If it adheres to the wound surface, do not force it off; moisten or soak the dressing with sterile saline or water until it can be removed without tissue disruption.
- Consult a physician if any of the following occur: infection, bleeding, maceration (skin whitening and softening), hypergranulation (excessive tissue formation), irritation at the wound and/or the surrounding skin, or if the wound increases in size.

Procellera™ Composite Antibacterial Wound Dressing

Instructions for Over-the-Counter Use

Description

Procellera™ Composite Antibacterial Wound Dressing (Procellera Composite) features V.Dox™ Technology. Embedded in the dressing are microcell batteries made of elemental silver and elemental zinc applied in a dot-matrix pattern to a polyester substrate. In the presence of a conductive medium such as wound exudate, water-based wound hydrogels, saline, or water, microcurrents are generated at the dressing surface due to its inherent design.

Procellera Composite is a three-layer dressing, comprising a broad-spectrum antibacterial contact layer, a polyester-based absorbent layer, and a polyurethane semi-occlusive outer adhesive layer to keep the dressing in place and help maintain a moist wound environment. Note: Product is not made with natural rubber latex.

Silver and zinc in the dressing help to preserve it and minimize or prevent the growth of bacteria within the dressing.

Indications

Procellera Composite Antibacterial Wound Dressing is intended for the management of wounds to provide a moist wound environment and is indicated for superficial wounds such as minor cuts, scrapes, irritations, abrasions, blisters, etc.

Contraindications

- Do not use on individuals with sensitivity or allergy to silver, zinc, or other dressing components.

Warnings

- Frequent or prolonged use of this product may result, in rare occasions, in temporary discoloration of the skin.

Precautions

- Single use only.
- For external use only.
- Do not use if the pouch is open or damaged prior to use.
- Do not apply Procellera Composite with topical agents such as antibiotic creams or ointments, enzymatic debriders, silver or zinc creams, oxidizing agents, or petroleum-based products.
- The use of adhesive dressings on fragile or sensitive skin may pose a risk of skin damage upon removal of the dressing. To mitigate this risk, a skin prep may be applied on the wound perimeter prior to dressing application (not included).
- Stop using Procellera Composite and consult a physician if allergy, irritation, increased pain, maceration, or irregular skin discoloration occurs.
- Procellera Composite is not intended to be used on wounds with uncontrolled bleeding.
- Remove Procellera Composite during energy-based procedures (such as radiofrequency, ultrasound, or radiation) where the dressing may interfere with delivery.
- MR unsafe. Remove Procellera Composite prior to a MRI or HBOT procedure and apply a new dressing after the procedure.
- Avoid direct dressing contact with electrodes or conductive gels during electronic measurements; e.g., EEG (electroencephalogram) or ECG (electrocardiogram).
- Infected wounds should be treated under a physician's supervision.
- The safety of daily Procellera Composite use for longer than 28 days has not been studied.

Application

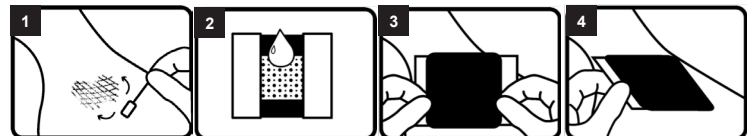

- Cleanse wound area with an appropriate wound cleanser.
- Peel back center liner to expose the dotted Procellera pad, leaving edge liners in place. Moisten the dotted Procellera pad with sterile saline, water, or a thin, even layer of wound hydrogel.
- Position the dotted Procellera pad over wound and gently press down to ensure direct contact.
Note: If dressing a joint, apply dressing while joint is slightly bent.
- Remove remaining liners and smooth adhesive down over skin.

Site Care and Dressing Change

- Procellera Composite may be left in place for up to 7 days. Earlier and/or more frequent changes may be required, depending on the amount of drainage present and the condition of the wound and/or the surrounding skin. Inspect the wound site periodically.
- To remove Procellera Composite, lift one corner and gently pull back in the direction of the wound. If it adheres to the wound surface, do not force it off; moisten or soak the dressing with sterile saline or water until it can be removed without tissue disruption.
- Consult a physician if any of the following occur: infection, bleeding, maceration (skin whitening and softening), hypergranulation (excessive tissue formation), irritation at the wound and/or the surrounding skin, or if the wound increases in size.